

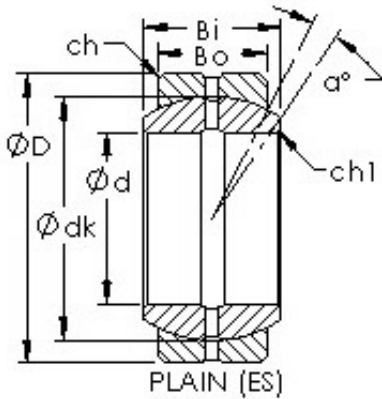

Shandong Chik Bearing Co., Ltd.



AST GEZ15ES plain bearings

Bearing No. GEZ15ES

Bore Diameter	15,875 mm
Outer Diameter	26,9875 mm
Bearing Type	plain
Bore Dia (d)	0.6250
Outer Dia (D)	1.0625
Outer Width (Bo)	0.4690
Inner Width (Bi)	0.5470
Dynamic Load Rating (Cr)	4,945
Static Load Rating (Cor)	14,612
Max. shaft corner radius, or 45 deg. chamfer (ch1)	0.006
Max. housing corner radius, or 45 deg. chamfer (ch)	0.024
Spherical Diameter (dk or Dk)	0.906
Mis-alignment Angle (a deg.)	6
Weight (g)	36.00
Material	52100 Chrome steel, or equivalent

GEZ15ES Bearing 2D drawings and 3D CAD models