

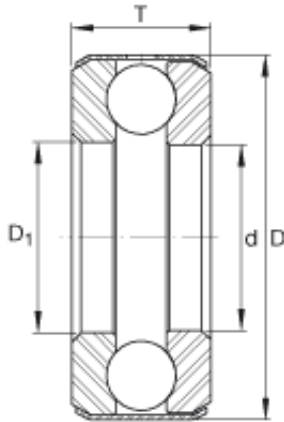

Shandong Chik Bearing Co., Ltd.



B37 Bearing 2D drawings and 3D CAD models

INA B37 thrust ball bearings

Bearing No. B37

Size	69.85x113.51x28.58 mm
Bore Diameter	69,85 mm
Outer Diameter	113,51 mm
Width	28,58 mm
d	2 3/4 inch
d	69,85 mm
D	4,469 inch
D	113,51 mm
T	1,125 inch
T	28,58 mm
D ₁	2,781 inch
m	2,265 lbs / Weight
m	1,027 kg / Weight
C _a	21400 lbf / Dynamic load rating (axial)
C _a	95000 N / Dynamic load rating (axial)
C _{0a}	57000 lbf / Static load rating (axial)
C _{0a}	254000 N / Static load rating (axial)
Category	Thrust Ball Bearing
Inventory	0.0
Manufacturer Name	SCHAEFFLER GROUP
Minimum Buy Quantity	N/A
Weight / Kilogram	1.23
Product Group	B00308



Shandong Chik Bearing Co., Ltd.

Rolling Element	Ball Bearing
Thrust Bearing	Yes
Single or Double Direction	Single Direction
Banded	Yes
Cage Material	Steel
Precision Class	ABEC 1 ISO P0
Component Description	Roller Assembly Plus Raceways
Other Features	Single Row With Flat Seat
Long Description	2-3/4" Bore 1; 2-25/32" Bore 2; 4-15/32" Outside Diameter; 1-1/8" Height; Ball Bearing; Single Direction; Banded; Steel Cage; ABEC 1 ISO P0 Precision
Inch - Metric	Inch
Category	Thrust Ball Bearings
UNSPSC	31171552
Harmonized Tariff Code	8482.10.50.08
Noun	Bearing
Keyword String	Ball Thrust
Manufacturer URL	http://www.ina.com
Bore 1	2.75 Inch 69.85 Millimeter
Bore 2	2.781 Inch 70.637 Millimeter
Overall Height with Aligning Washer	0 Inch 0 Millimeter
Height	1.125 Inch 28.575 Millimeter
Outside Diameter	4.469 Inch 113.513 Millimeter